

ichromaTM hsCRP

Test Setup

Test Components

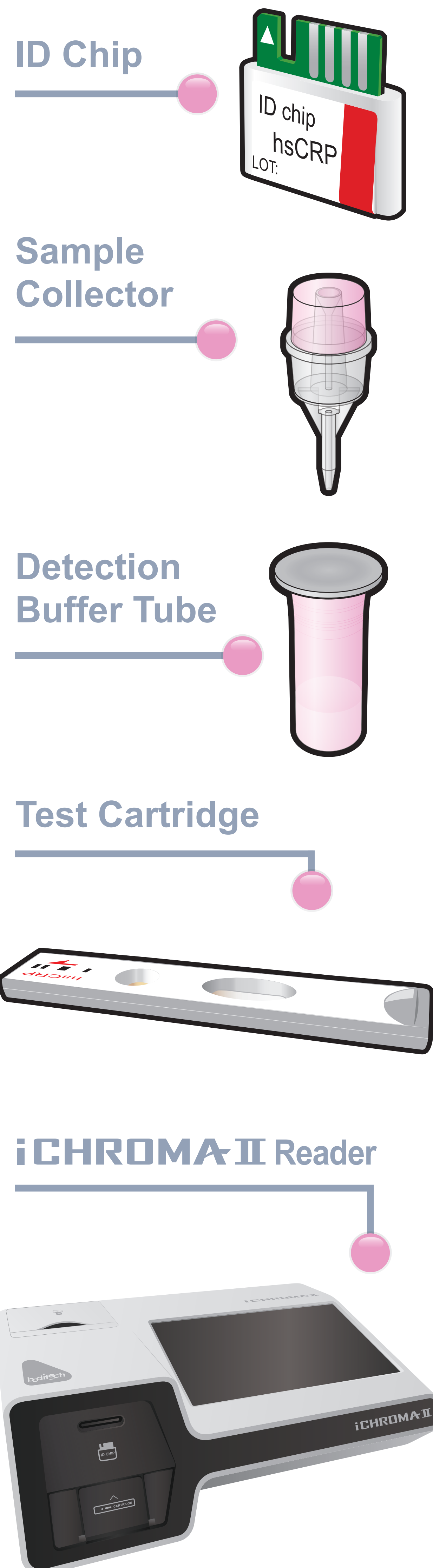

Important

Allow 'Detection Buffer Tube' to attain room temperature at least for 30 minutes before performing the test

Make sure that lot number of the 'ID Chip' is exactly same as the lot number of 'Test Cartridge' and 'Detection Buffer Tube'

1 Turn the power switch 'On'

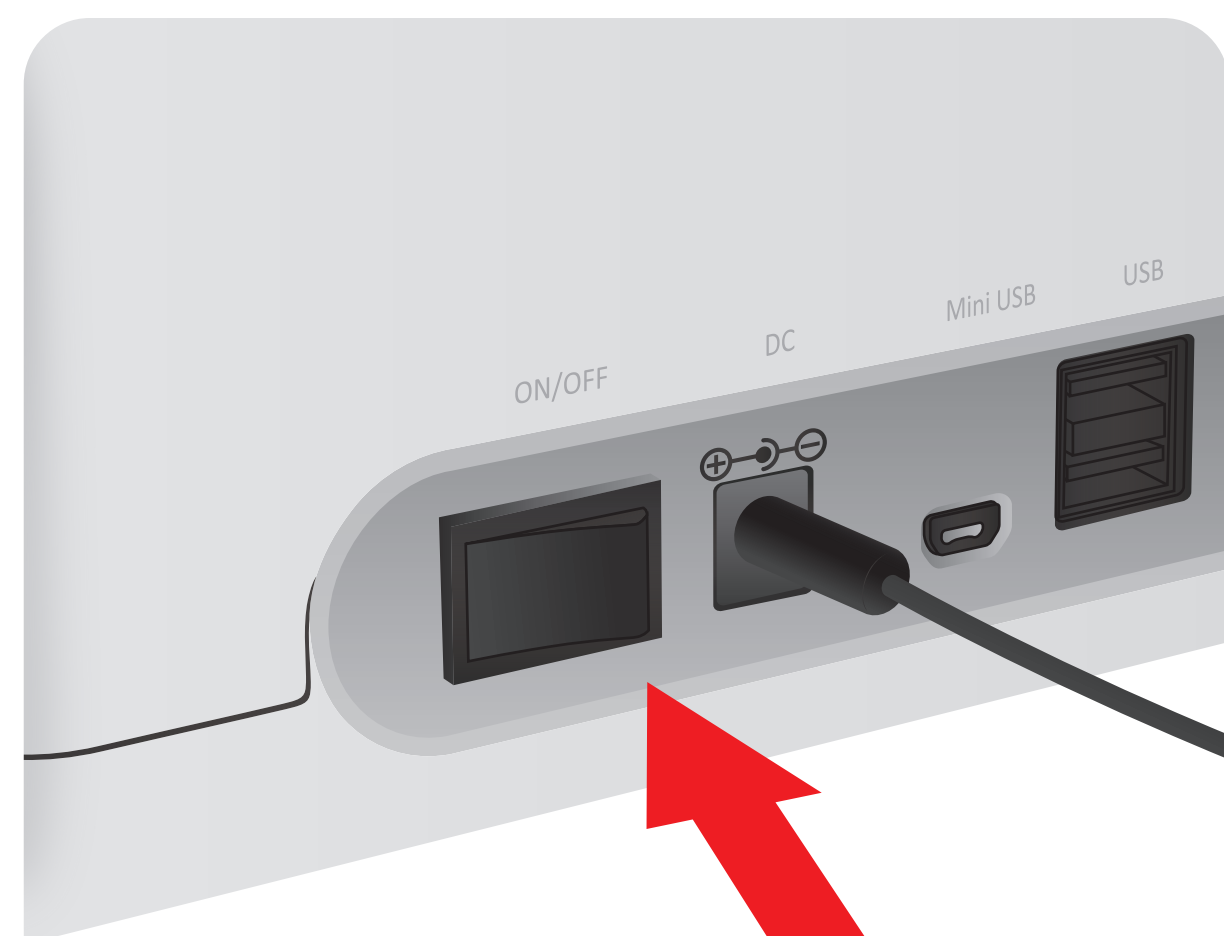

2 Insert ID Chip



3 Press 'Multi-test'

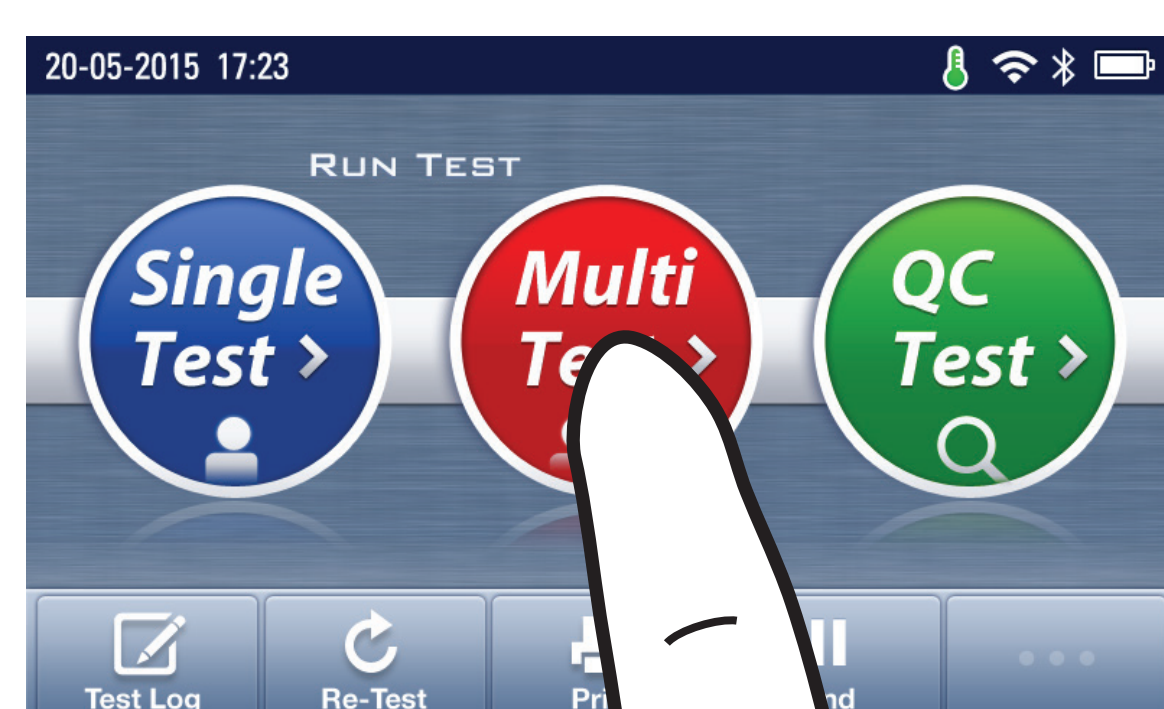

4 Make a Puncture

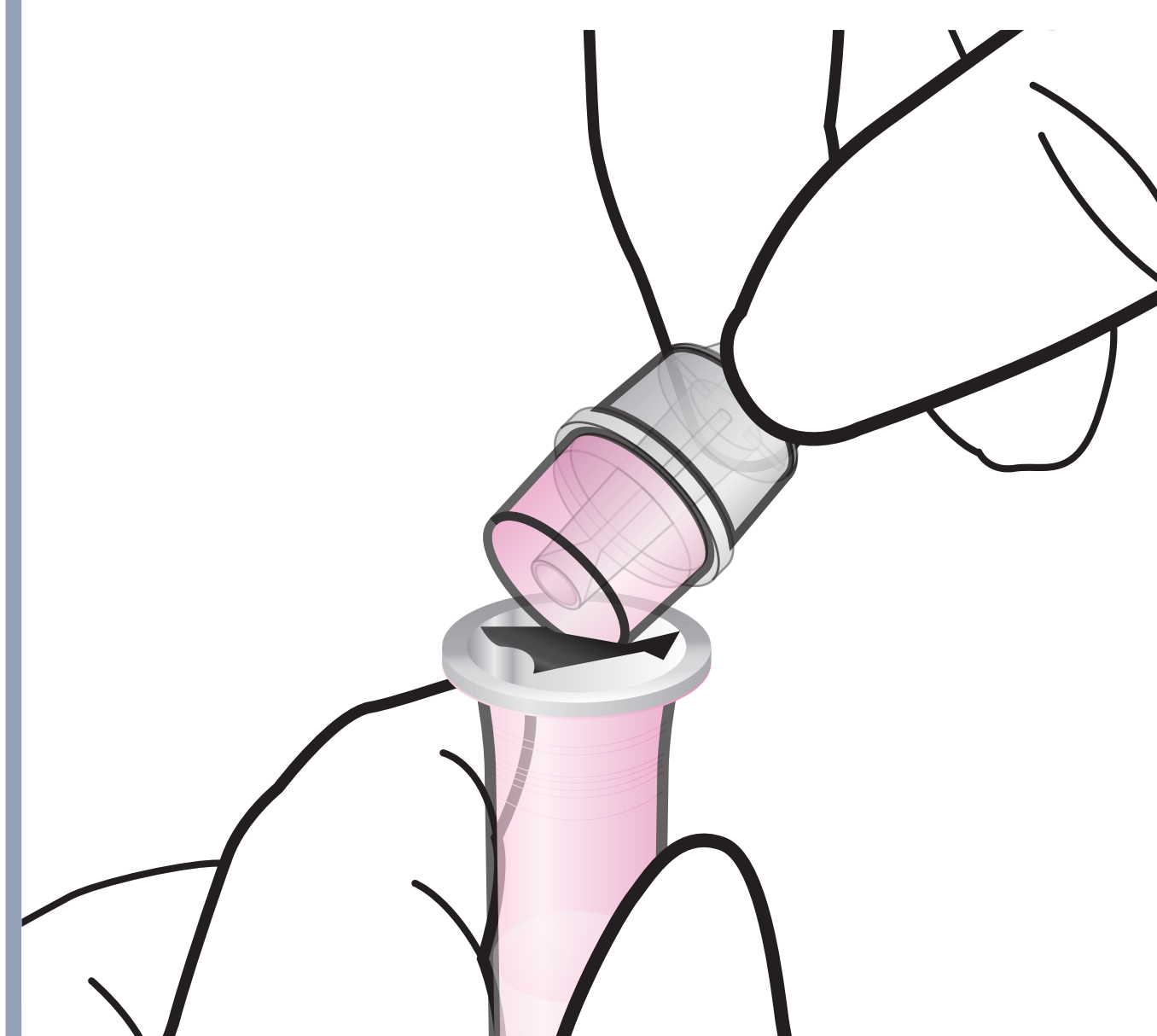

1 Draw whole blood

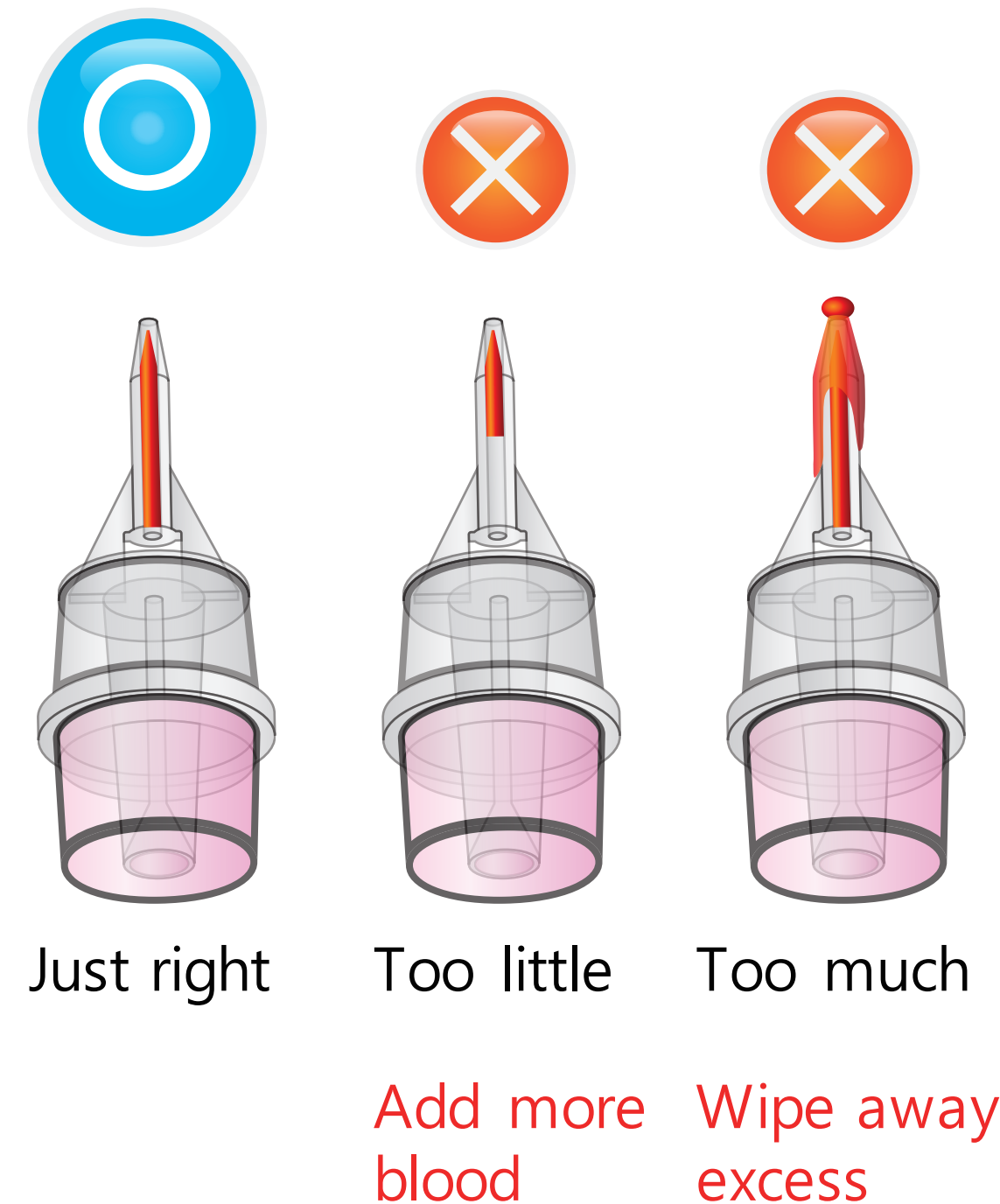
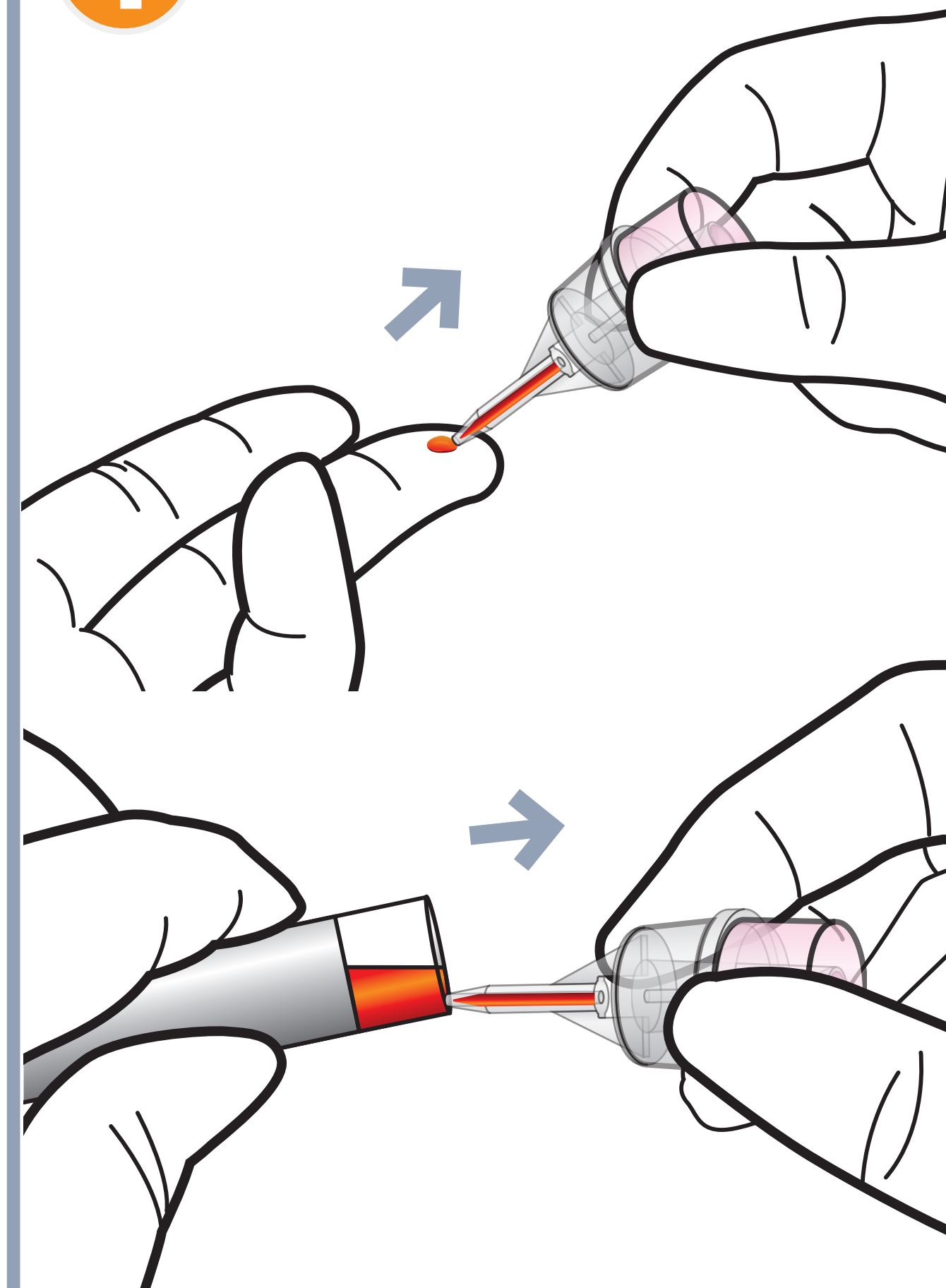

2 Assemble the sample collector with detection buffer tube

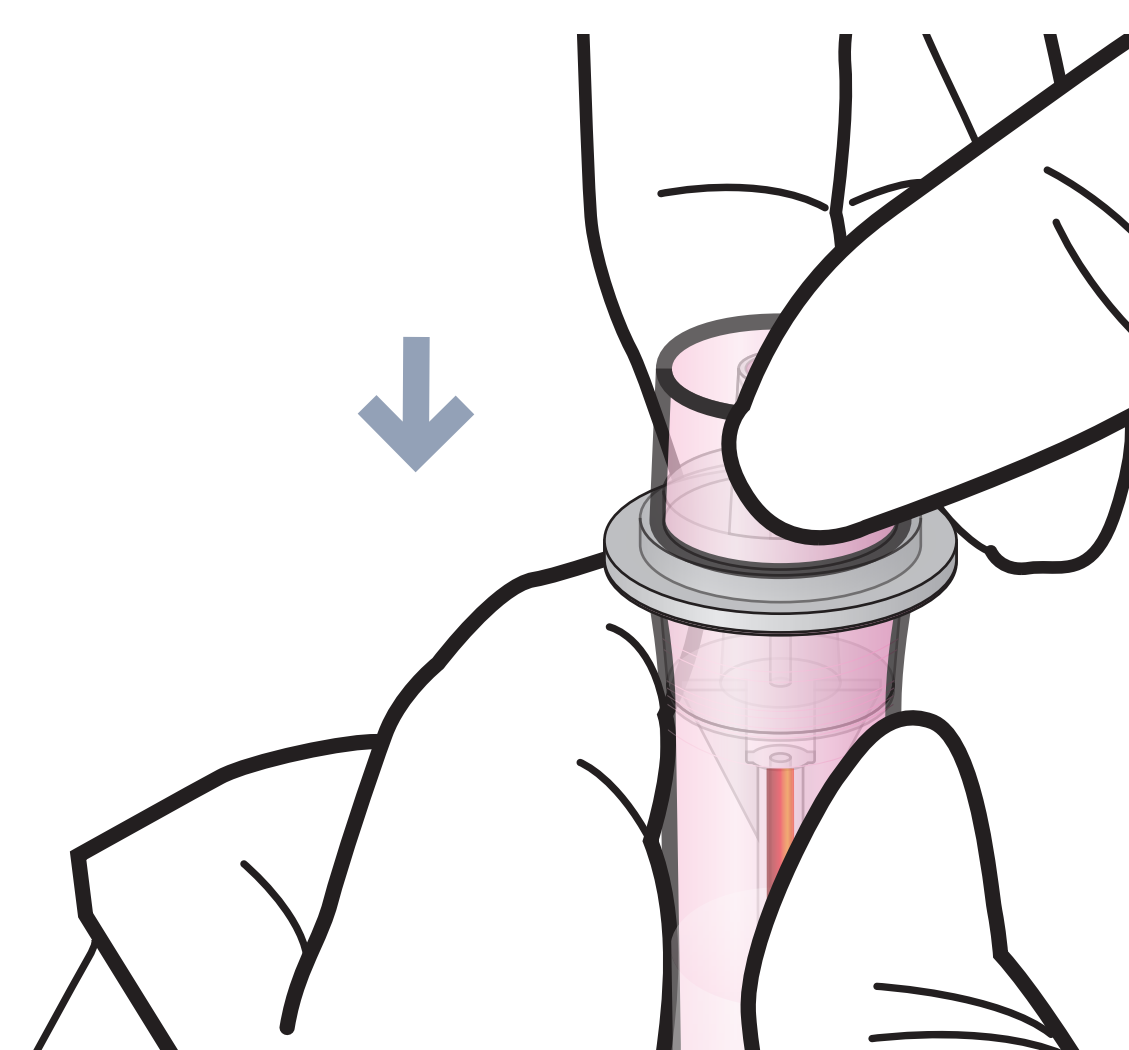
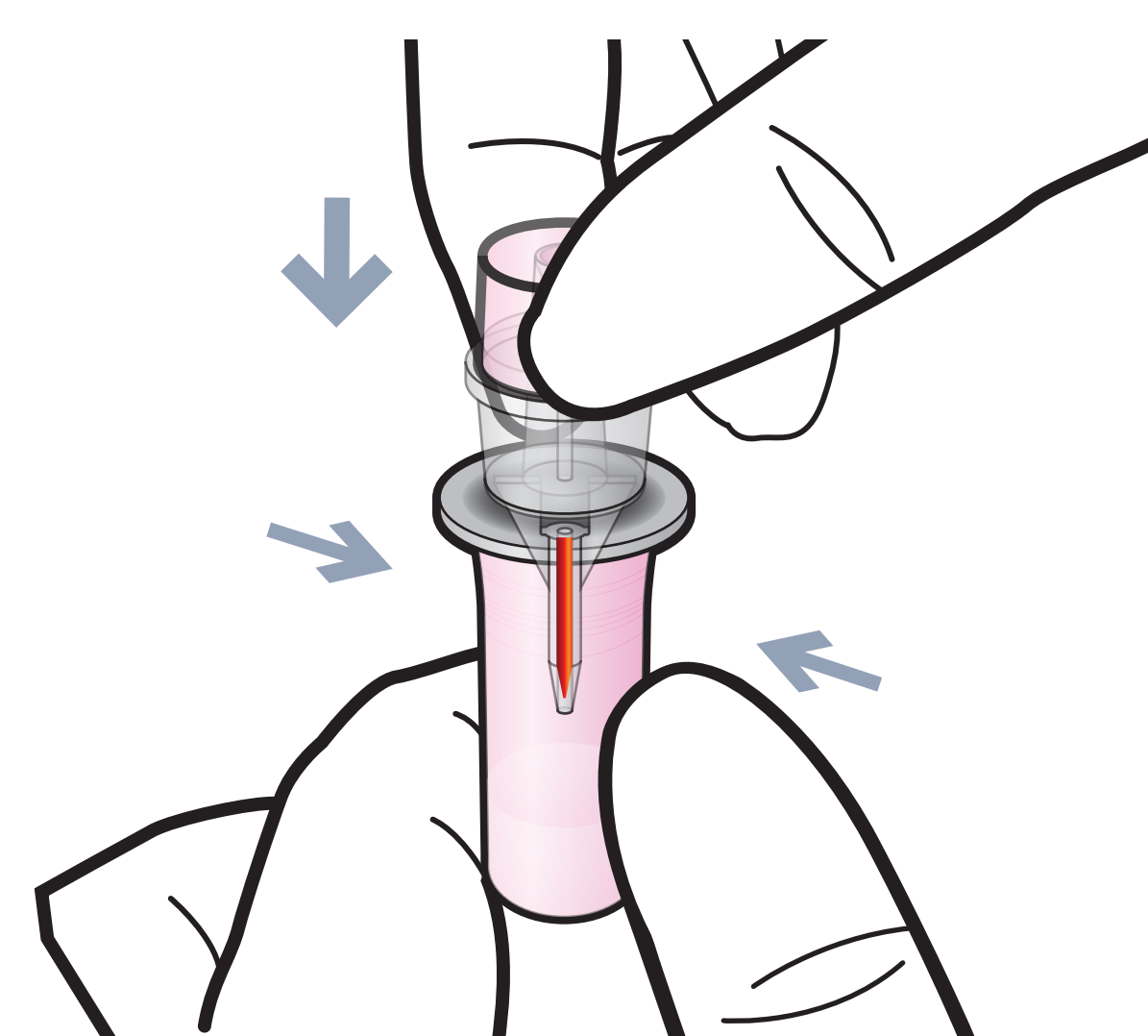

Test Procedure

3 Shake the tube

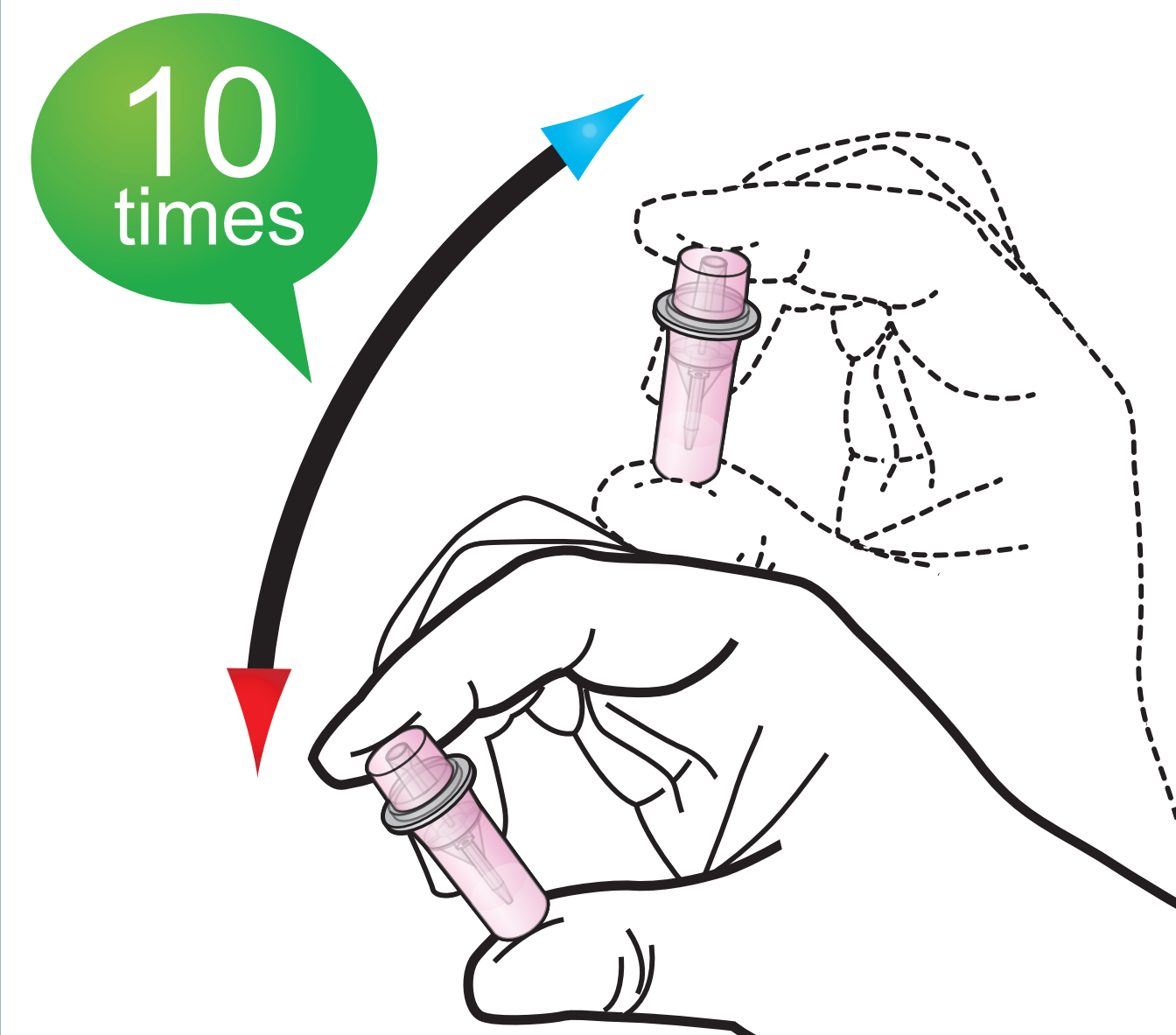

4 Discard two drops

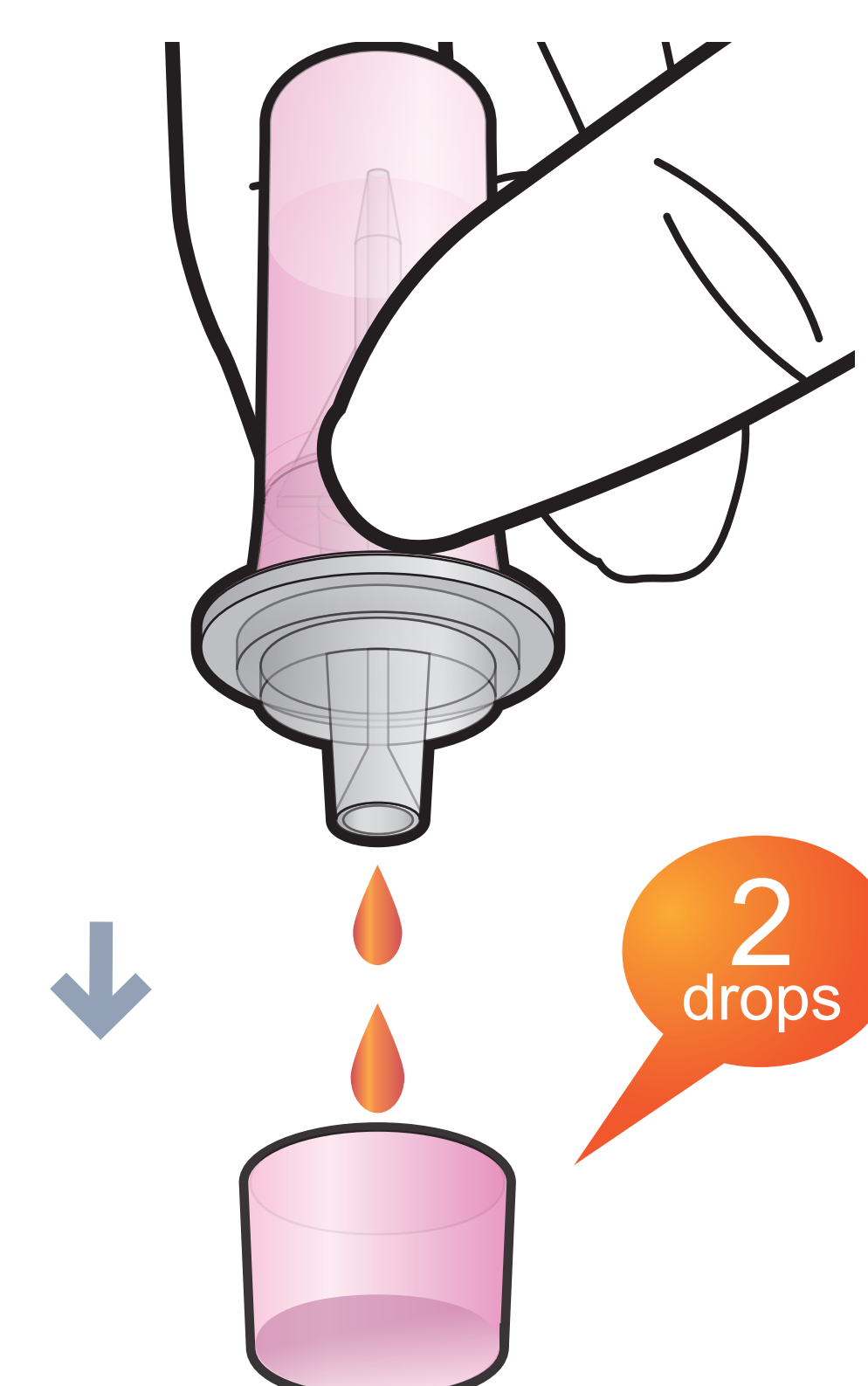

5 Load the sample mixture

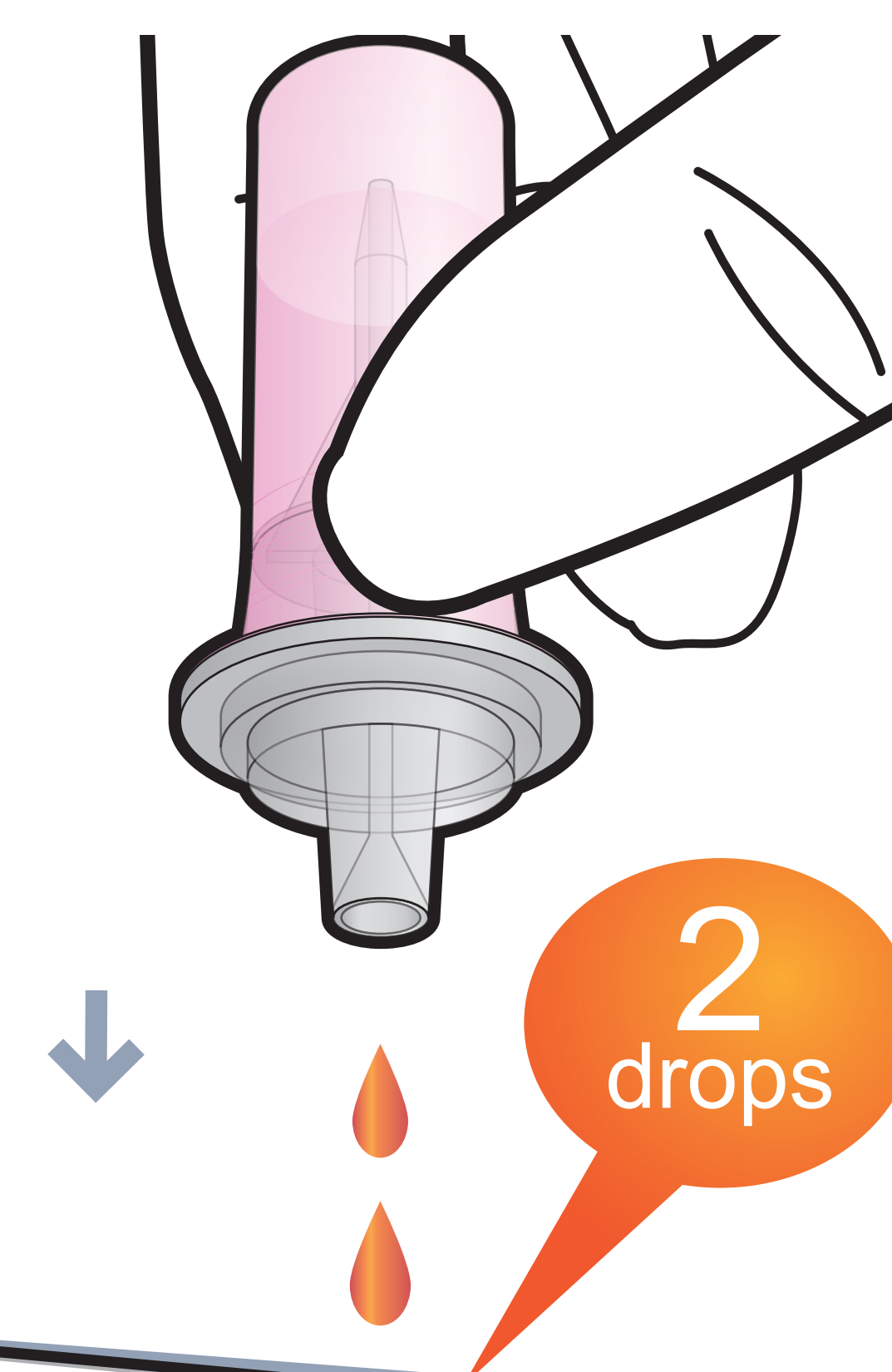

6 Insert the cartridge into ichromaTM II Reader

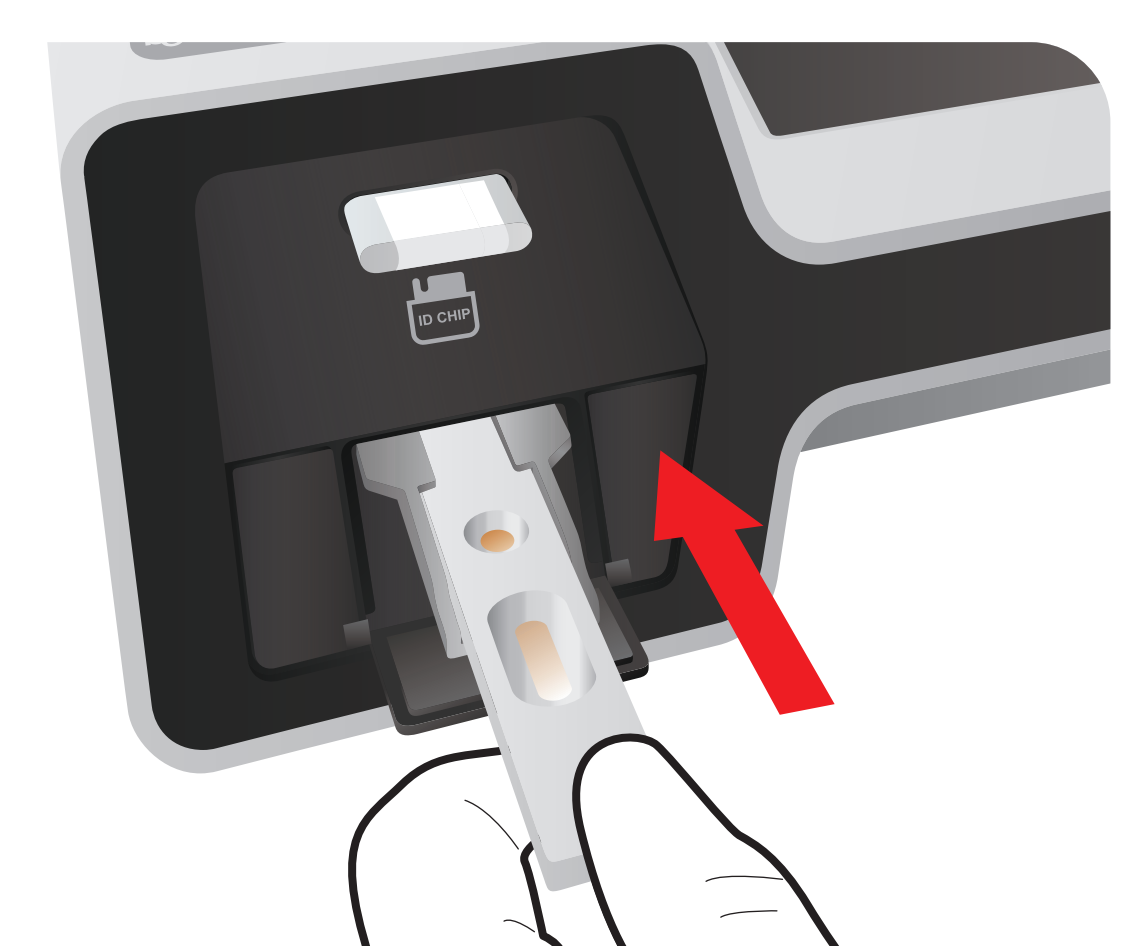

7 Press 'Select'

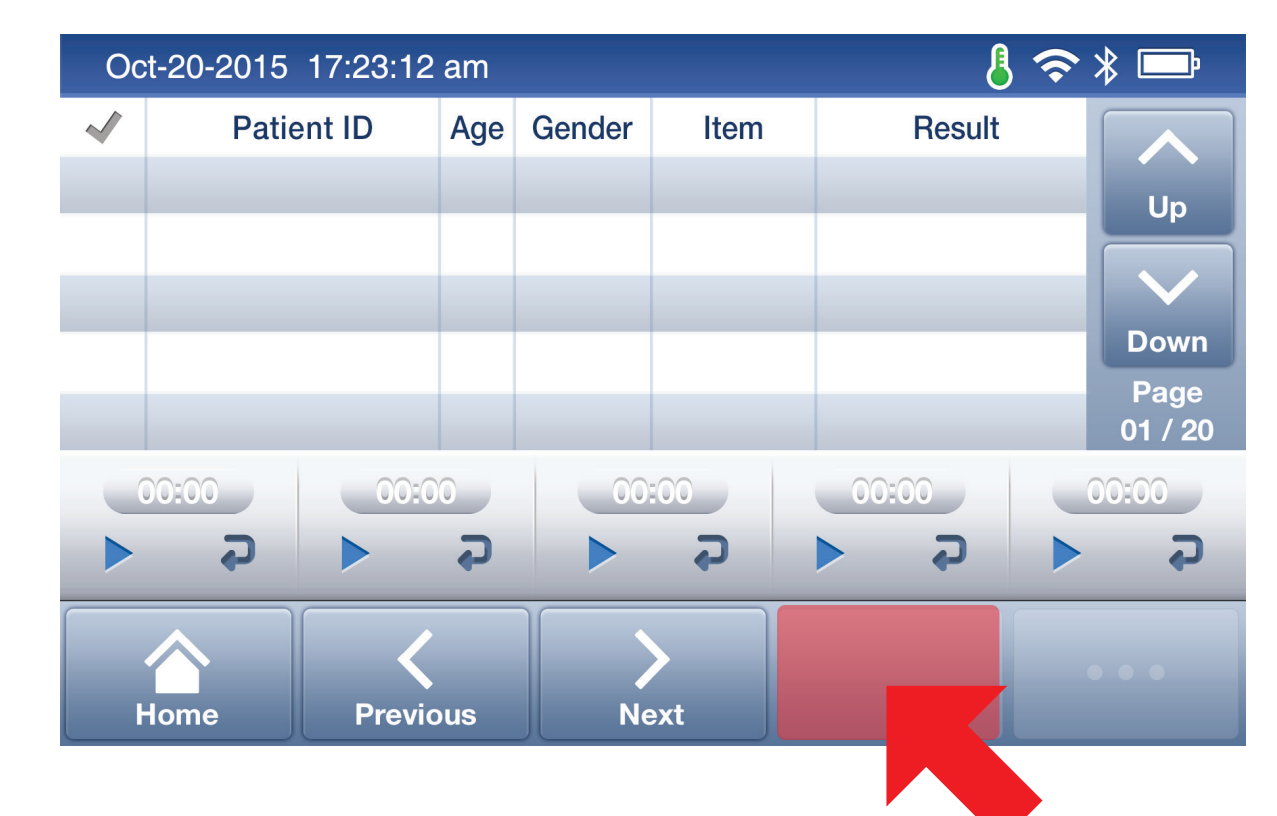

8 Read the test result



Rev.01.190325_hscRP