

ichroma™ PSA

Test Setup

Test Components

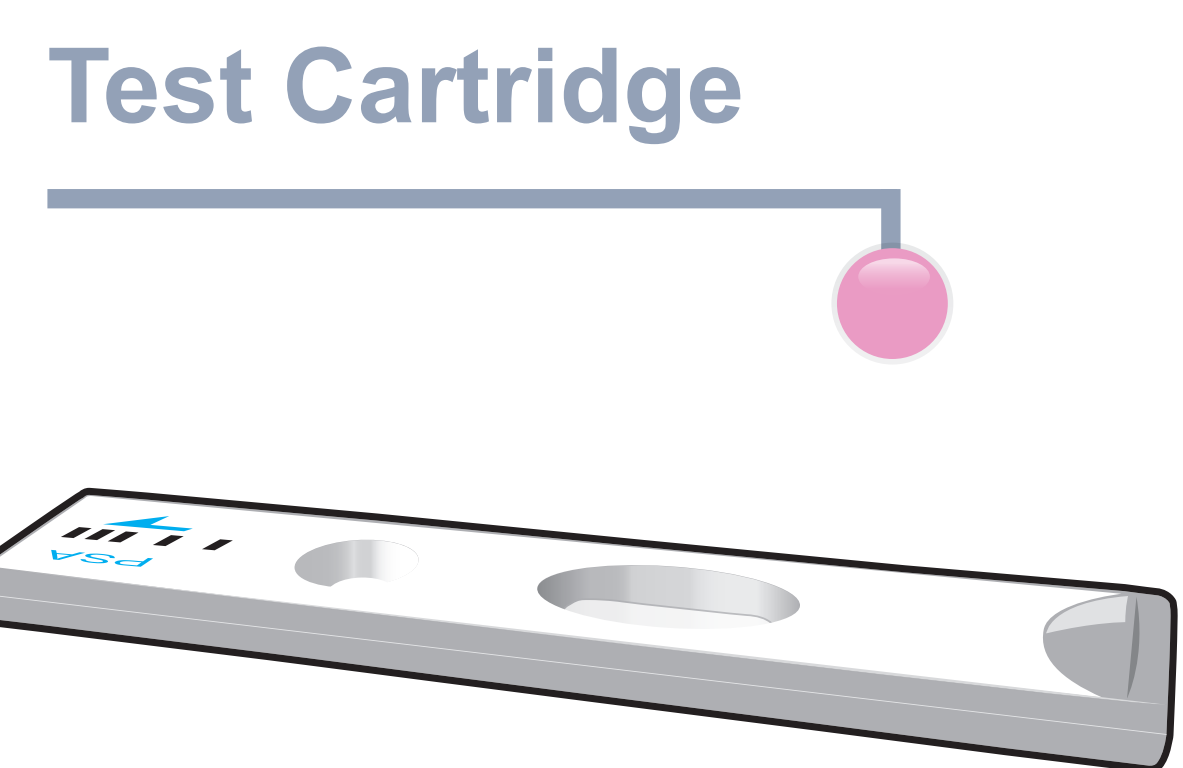
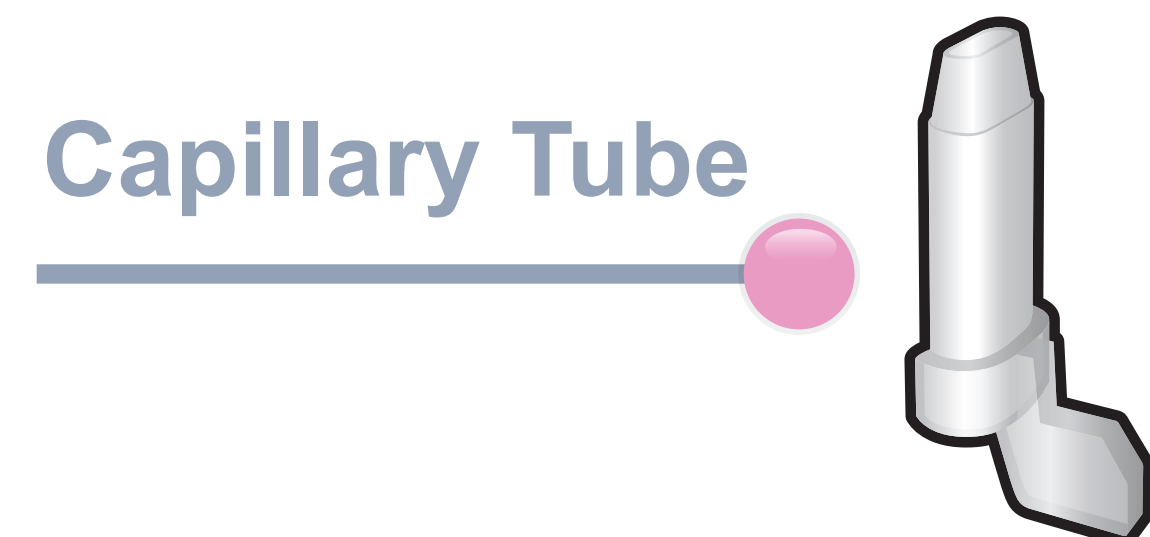
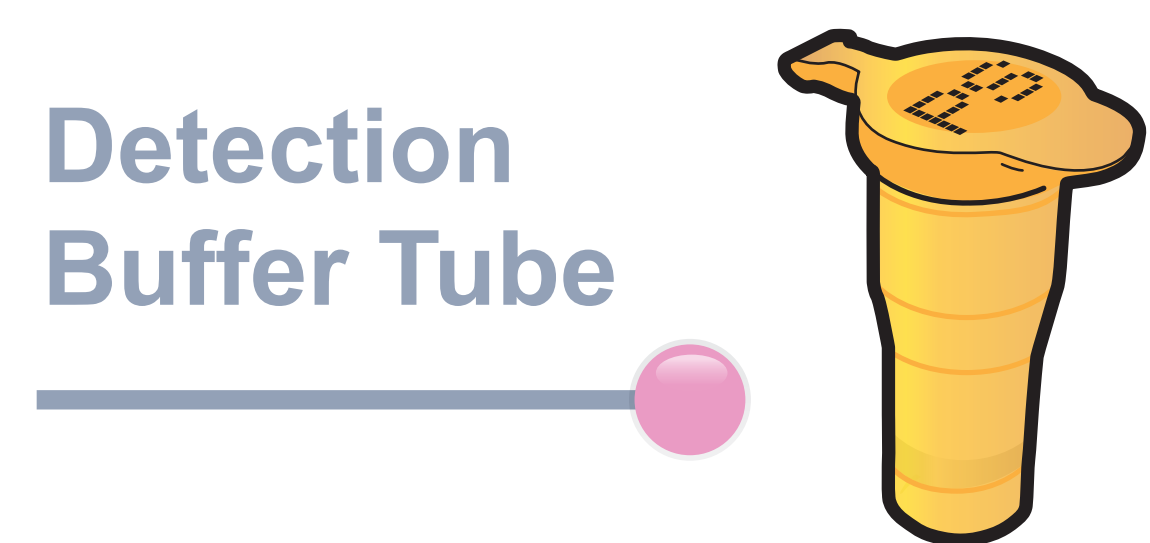
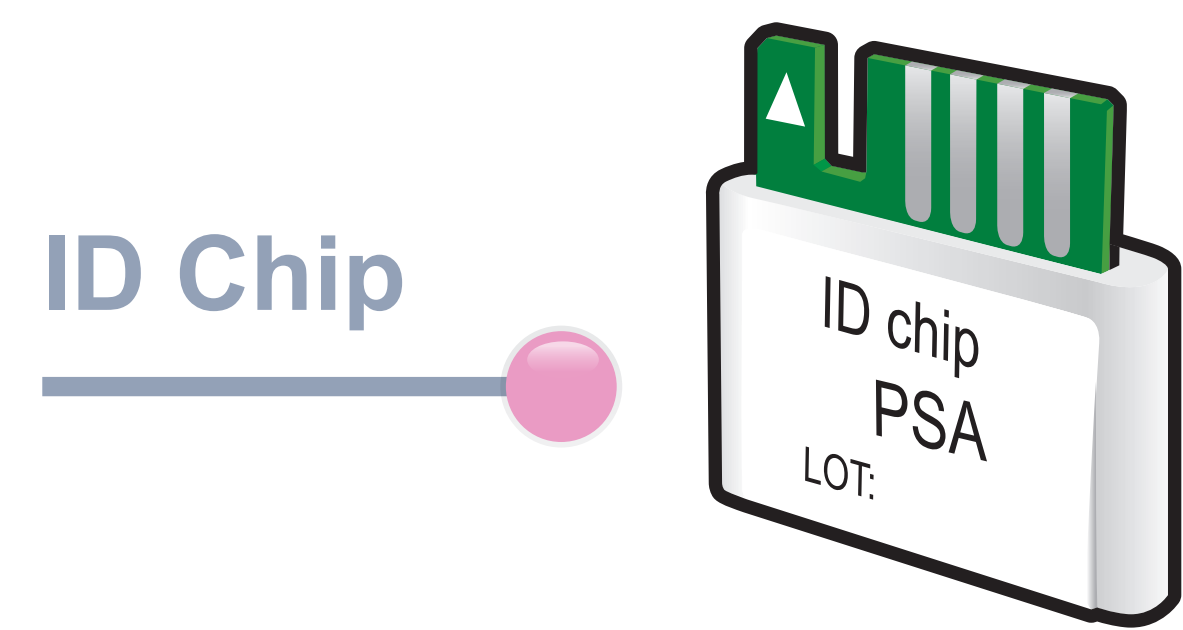

iCHROMA II Reader



Important

Allow 'Detection Buffer Tube' to attain room temperature at least for 30 minutes before performing the test

Make sure that lot number of the 'ID Chip' is exactly same as the lot number of 'Test Cartridge' and 'Detection Buffer Tube'

1 Turn the power switch 'On'

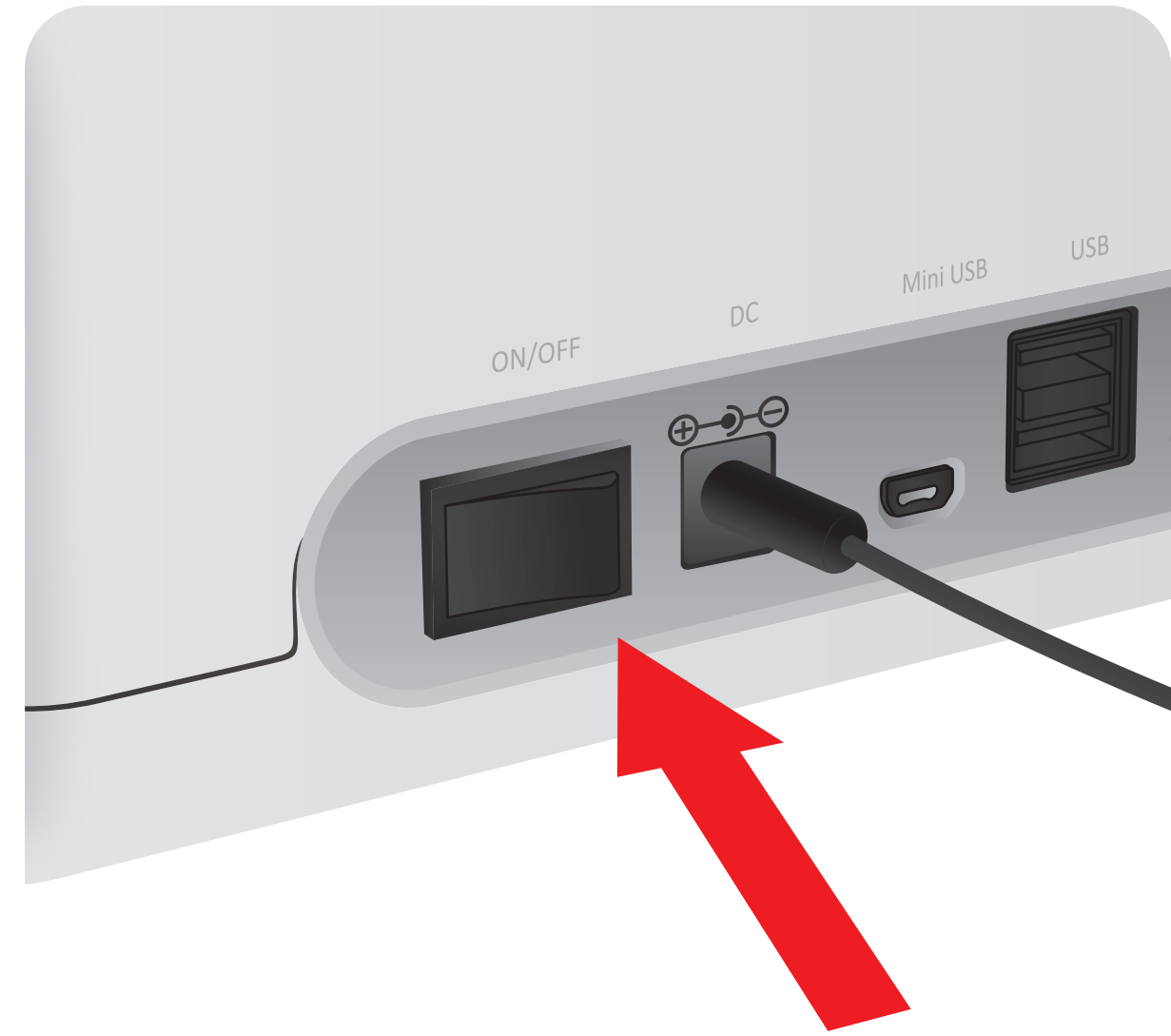

2 Insert ID Chip



3 Press 'Multi-test'

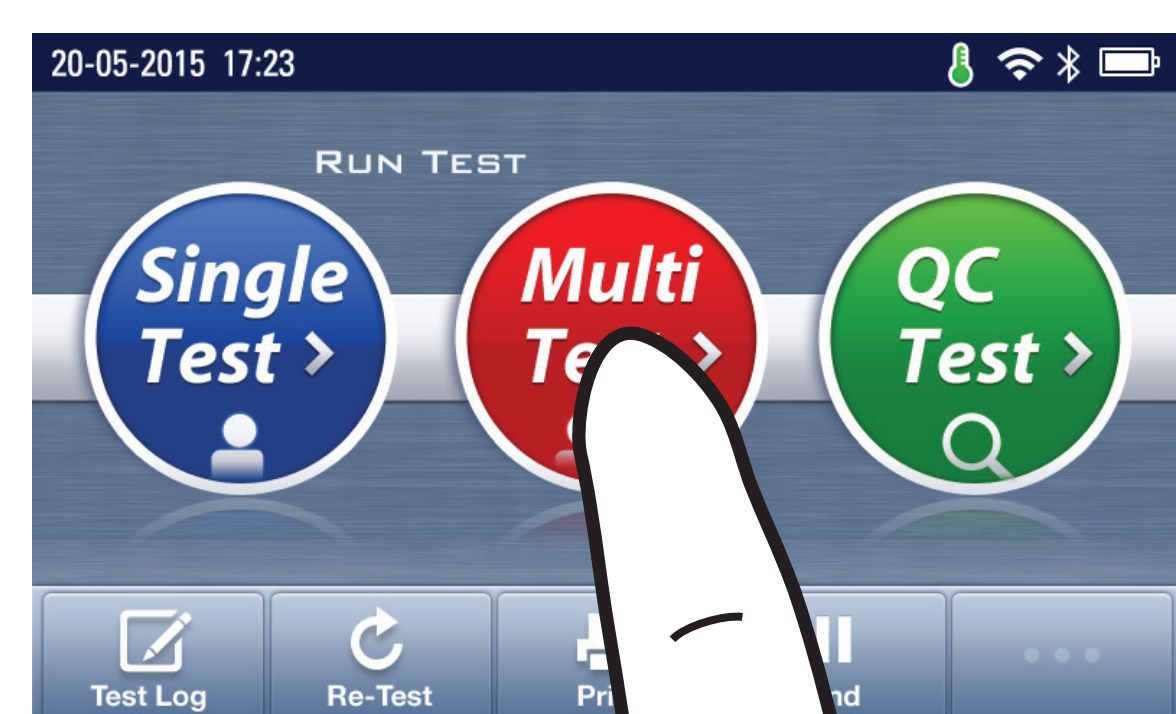

Test Procedure

In case of Serum, Plasma, Control

1 Draw Serum, Plasma, Control



2 Add it into detection buffer tube

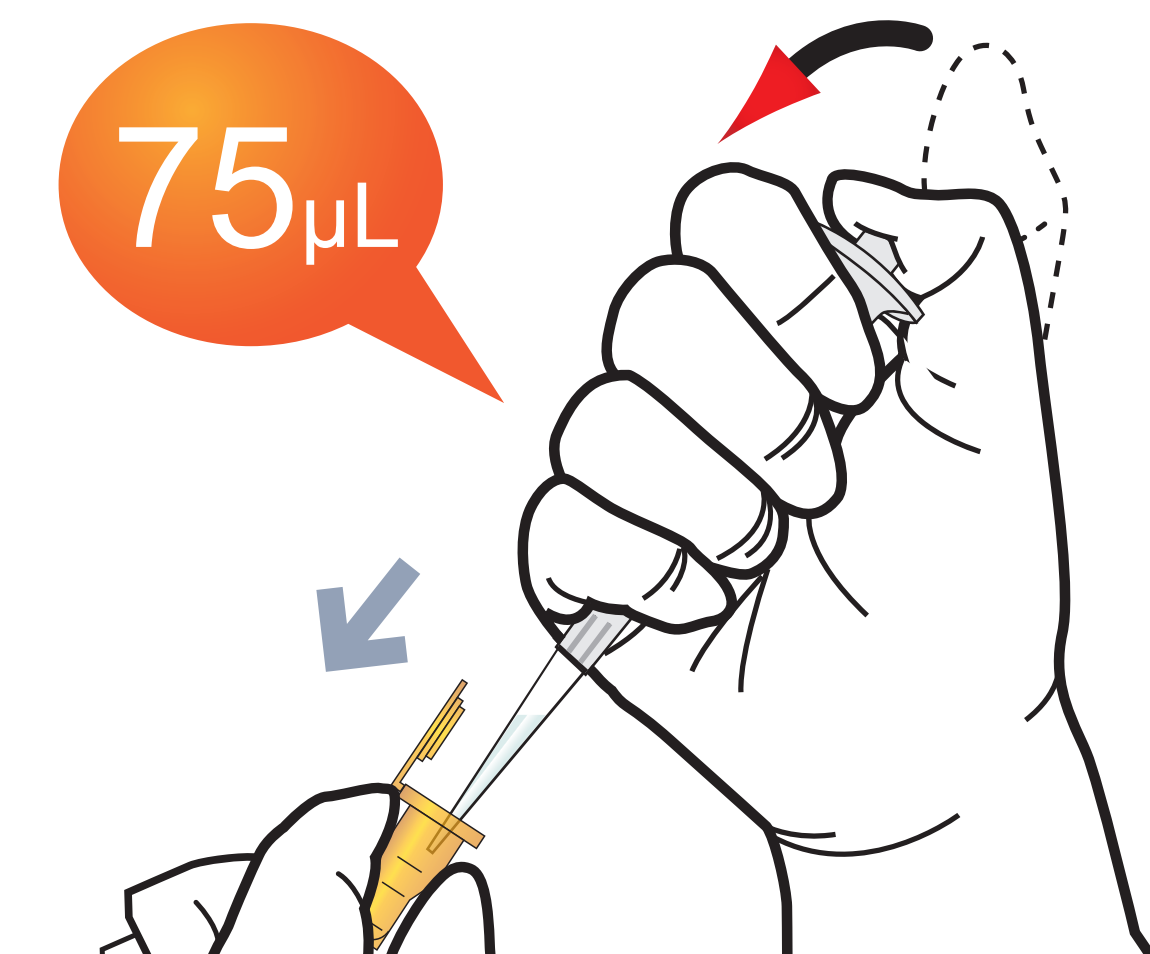

In case of Whole blood

1 Draw whole blood

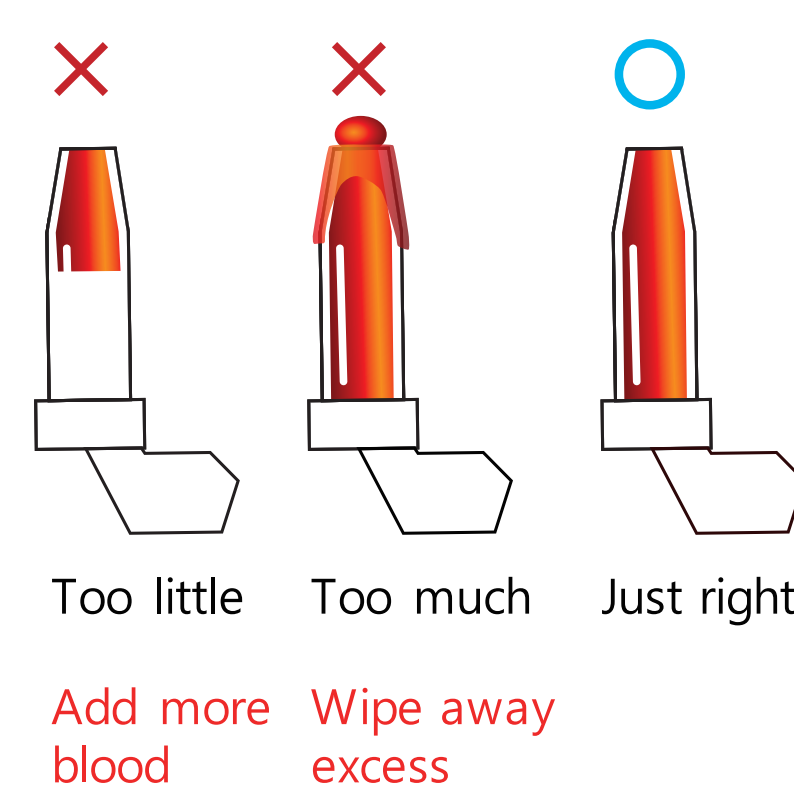
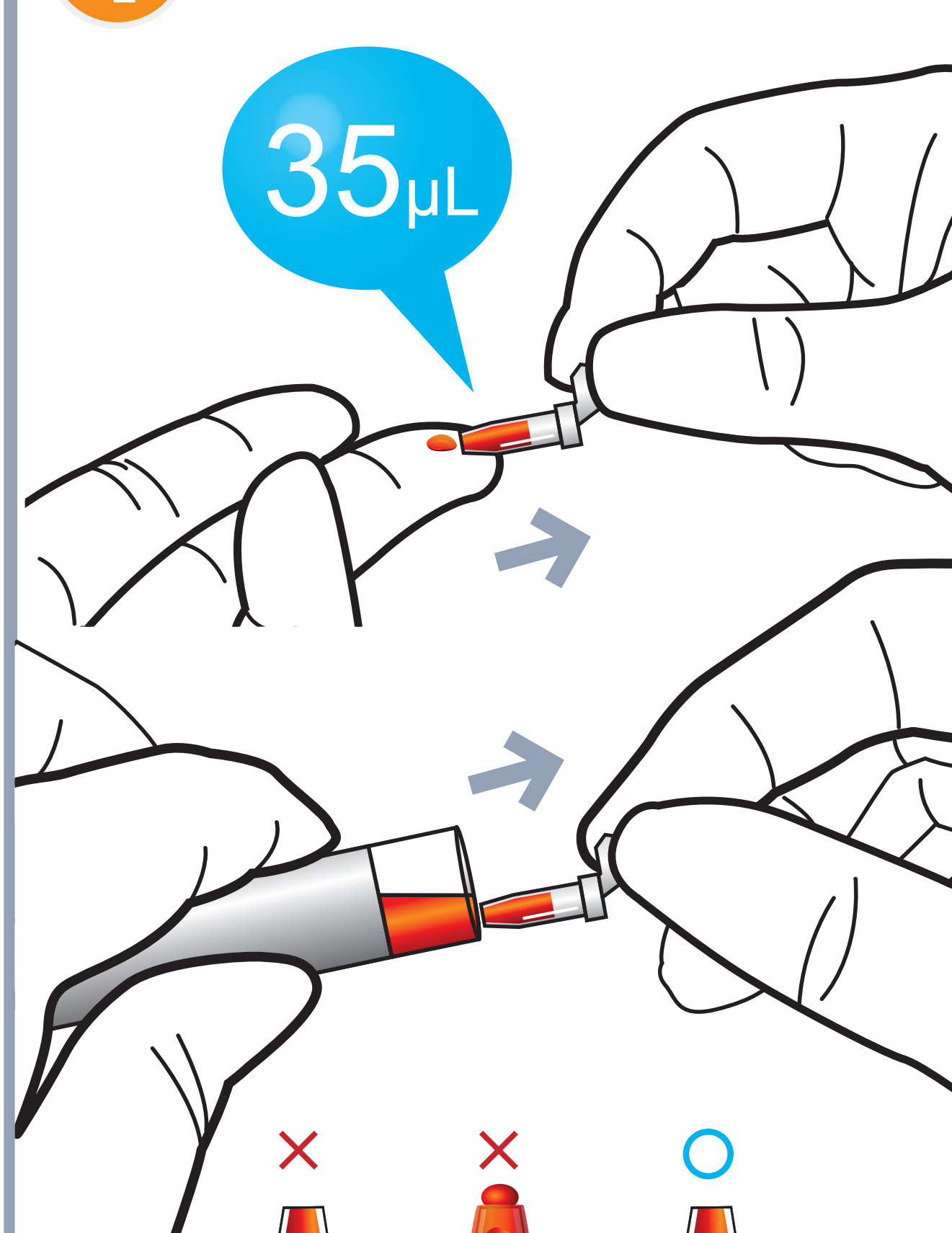

2 Put the Capillary

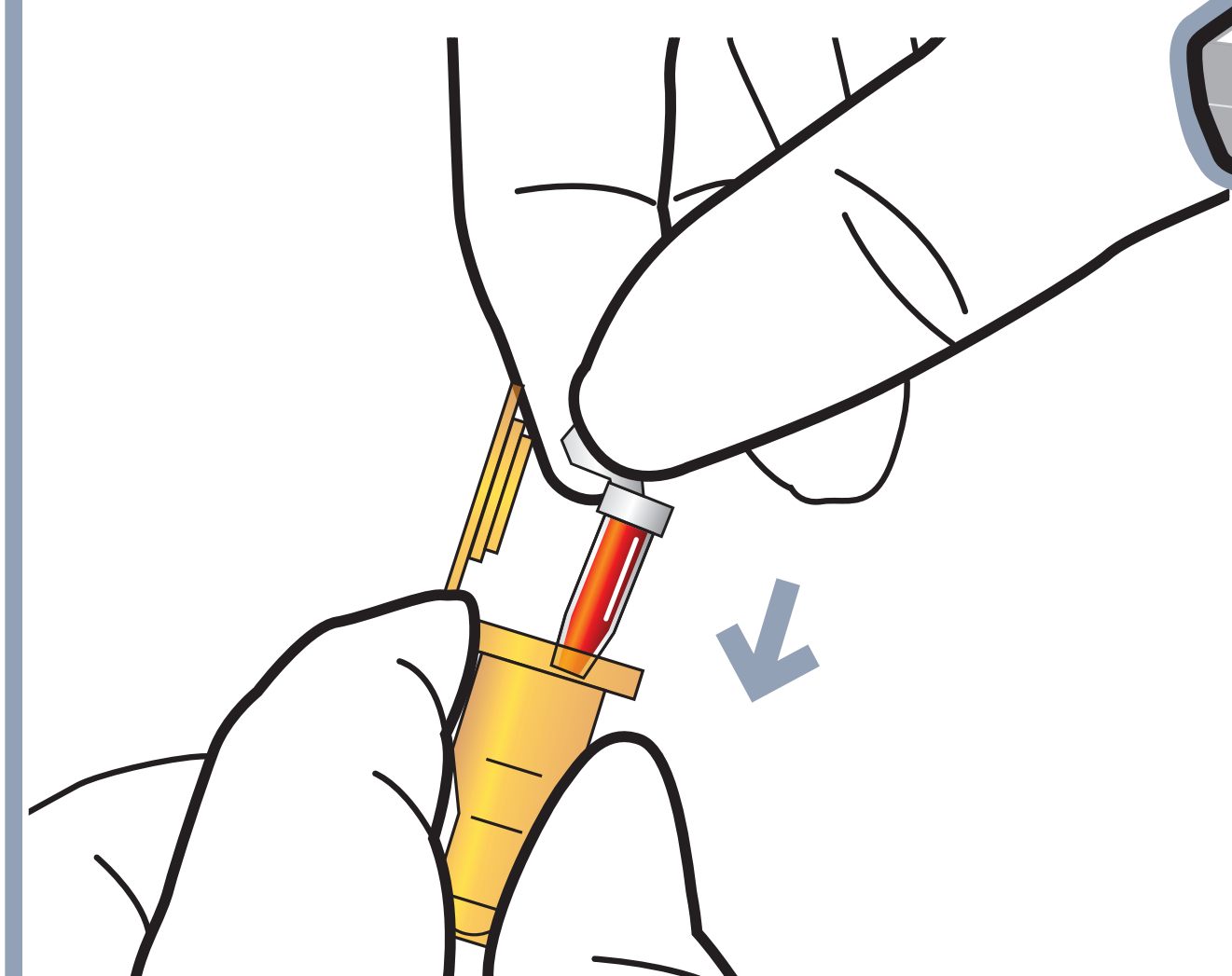

3 Shake the detection buffer tube

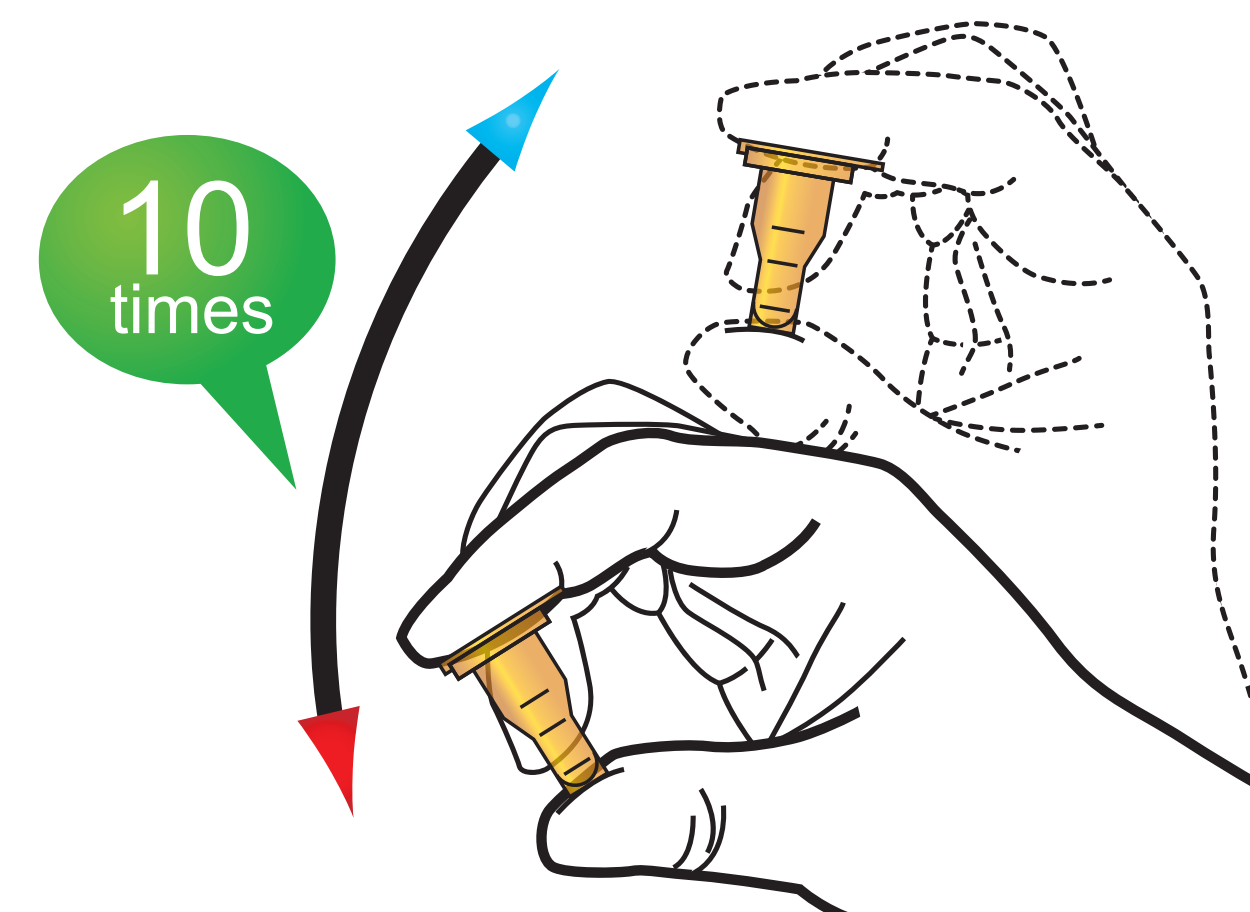

4 Draw the detection buffer tube

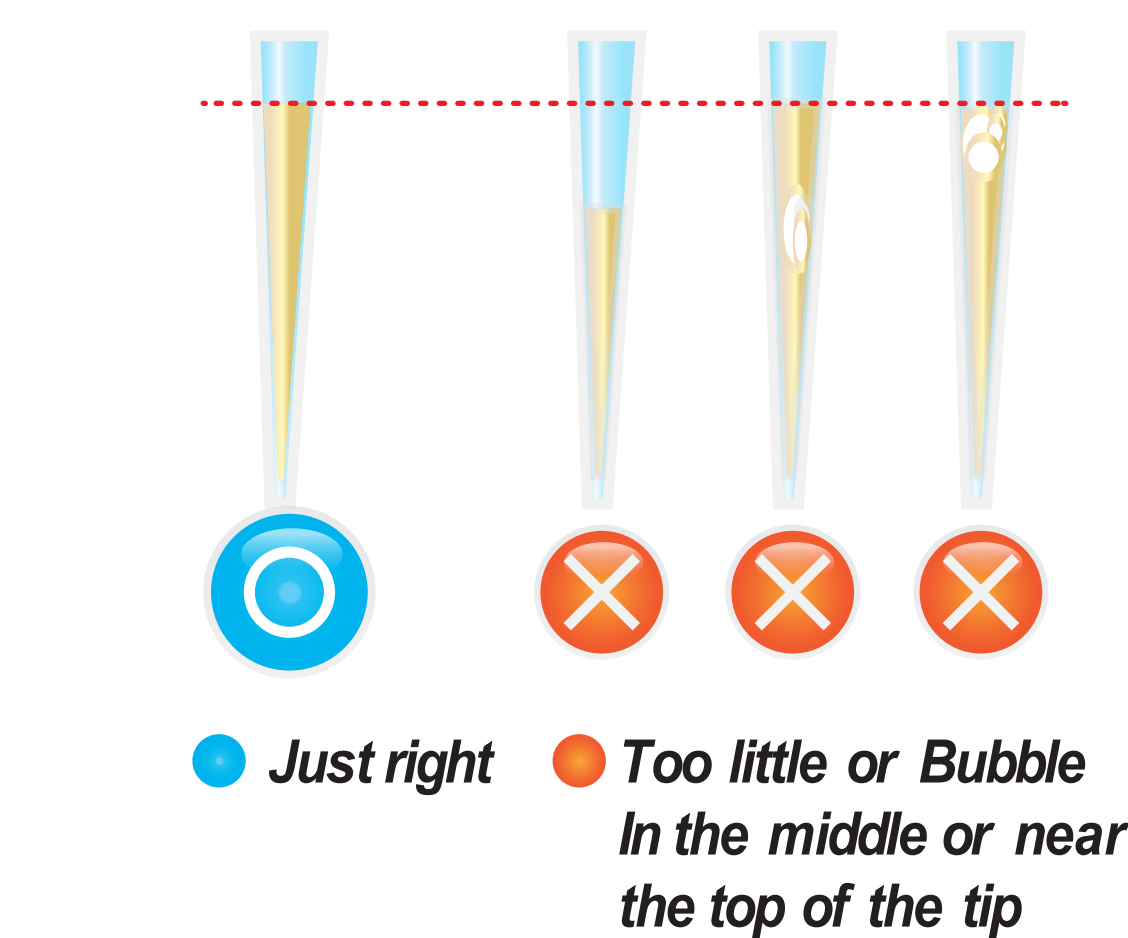
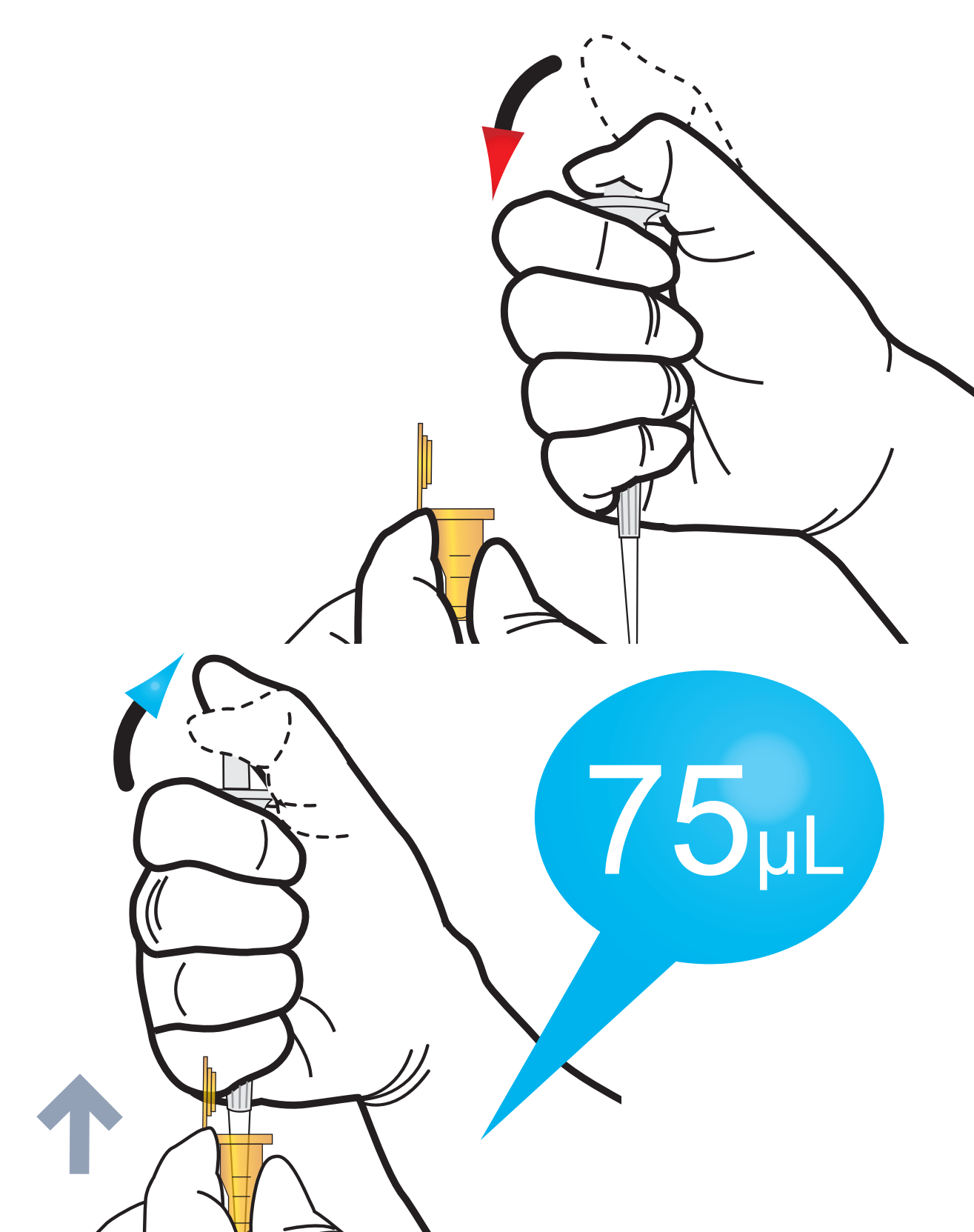

5 Load the sample mixture



6 Waiting 15 minutes

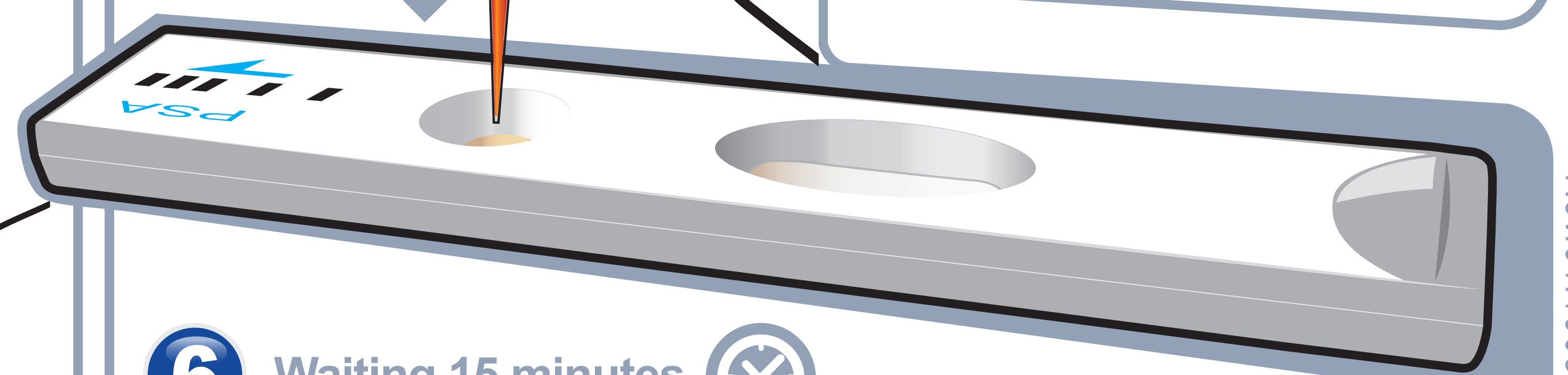

7 Insert the cartridge into ichroma™ II Reader

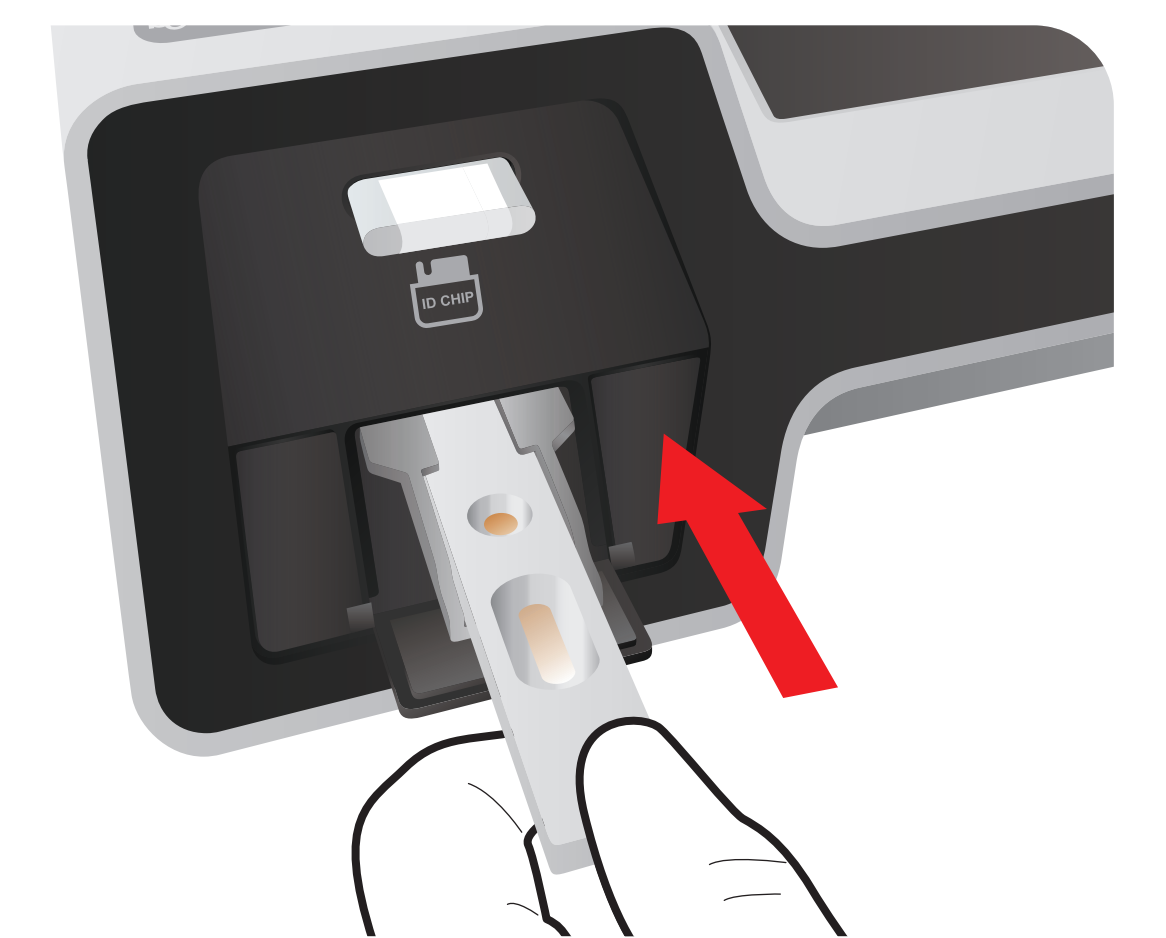

8 Press 'Select'

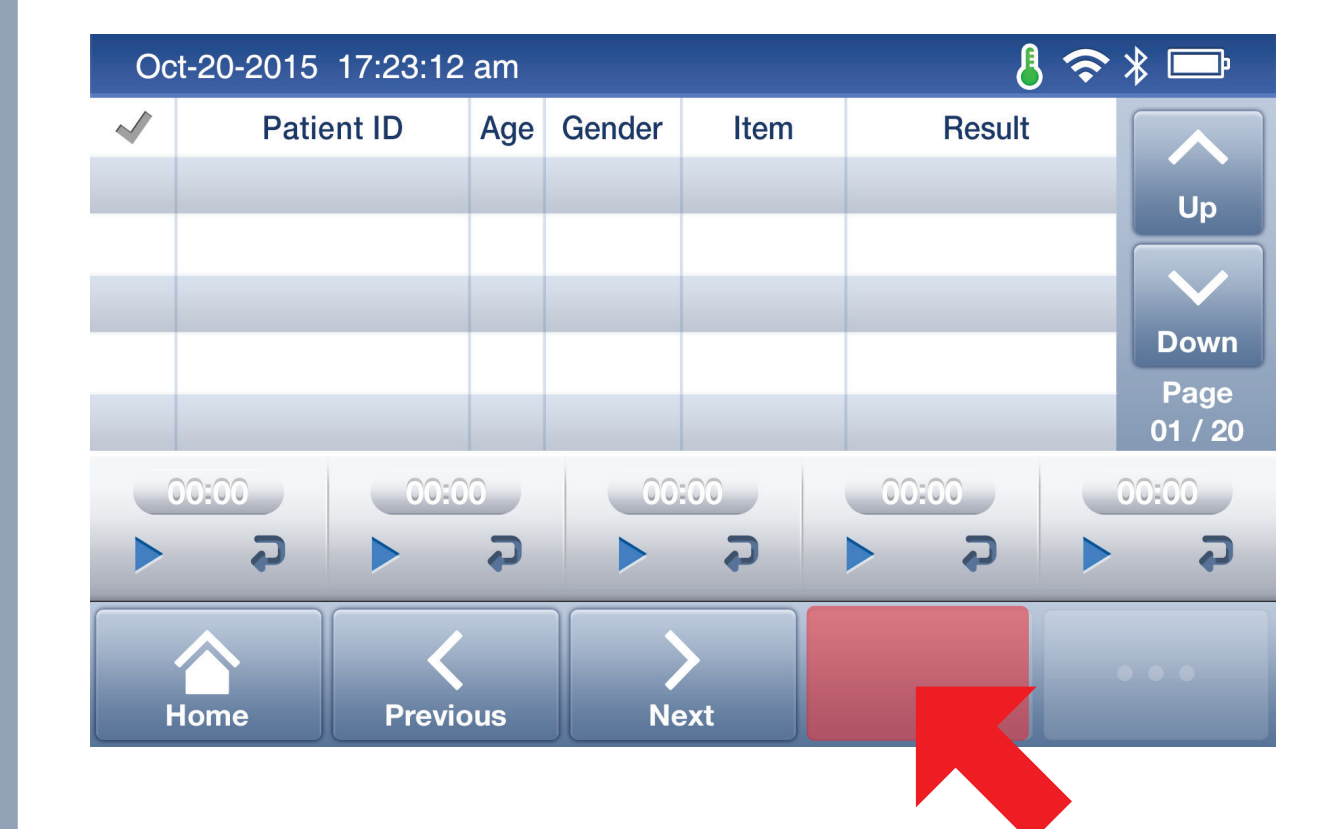

9 Read the test result



Rev.01.190325_PSA